



## Features

- Surface Mount / Single-Turn Cermet / Process Sealed
- Elastomer seal allows multiple adjustments (5 rotations)
- Compatible with all surface mount manufacturing processes
- Recommended for reflow processing only

- Cross-slot rotor design suitable for automatic adjustment equipment
- Supplied in 12mm embossed tape, compatible with automatic pick-and-place assembly equipment
- Patent #5,095,298
- Plastic rotor minimizes RF & ESD concerns

# 3374 - 4mm Square Trimming Potentiometer

## Electrical Characteristics

Standard Resistance Range ..... 10 to 2 megohms  
(see standard resistance table)  
Resistance Tolerance ..... ±20% std.  
End Resistance ..... 1% or 2 ohms max.  
(whichever is greater)  
Contact Resistance Variation ..... 3% or 3 ohms max.  
(whichever is greater)  
Resolution ..... Infinite  
Adjustment Angle ..... 240° nom.  
Maximum Voltage ..... 200V

## Environmental Characteristics

Power Rating  
70°C ..... 0.25 watt  
125°C ..... 0 watt  
Operating Temperature Range ..... -55°C to +125°C  
Temperature Coefficient  
<500K ohms ..... ±100ppm/°C  
≥500K ohms ..... ±150ppm/°C  
Seal ..... 5 turns min.  
Humidity ..... MIL-STD 202 Method 103  
Vibration ..... 20G; TRS ±1%, VRS ±1%  
Shock ..... 100G; TRS ±1%, VRS ±1%  
Load Life (@70°C Rated Power, 1000 hours) ..... TRS ±3%  
Rotational Life ..... 100 cycles; TRS ±3%  
Thermal Shock ..... 5 cycles  
TRR ±2%, VRS ±1%

## Physical Characteristics

Torque ..... 18 - 180gm/cm  
Mechanical Angle ..... Continuous  
Marking ..... Manufacturer's trademark and part marking code  
Wiper ..... Positioned at 50% nominal  
Standard Packaging ..... 750 pcs./7" reel  
Adjustment Tool ..... H-90

## How To Order

**3374 X - 1 - 502 E**

Model \_\_\_\_\_  
Style \_\_\_\_\_  
Orientation of Parts in Tape:  
Style W - Terminals Toward Sprocket Holes  
Standard or Modified Product Indicator \_\_\_\_\_  
-1 = Standard Product  
Resistance Code \_\_\_\_\_  
Embossed Tape \_\_\_\_\_  
750 pcs./7" reel (standard)

Consult factory for other available options.

## 3374X/W

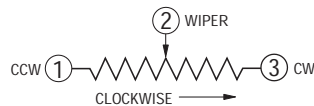
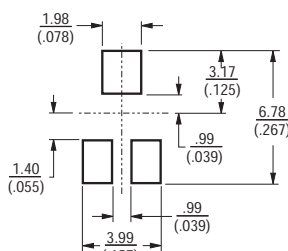
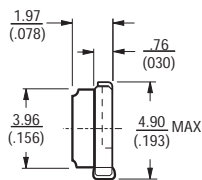
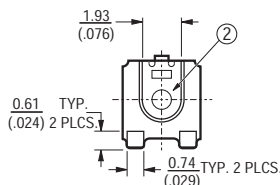
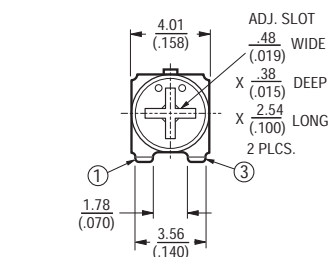

TOLERANCES: ± 0.25 (.010) EXCEPT WHERE NOTED

DIMENSIONS ARE: METRIC (INCHES)

## Packaging Specifications

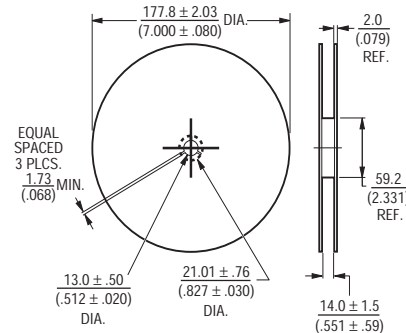
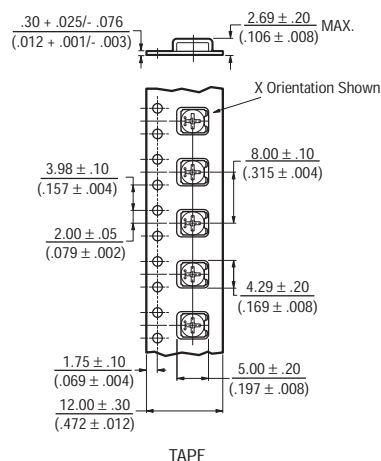

Meets EIA 481

## Standard Resistance Table

Resistance (Ohms)	Part Marking Code	Resistance Code
10	A1	100
20	21	200
50	51	500
<b>100</b>	<b>A2</b>	<b>101</b>
<b>200</b>	<b>22</b>	<b>201</b>
<b>500</b>	<b>52</b>	<b>501</b>
<b>1,000</b>	<b>A3</b>	<b>102</b>
<b>2,000</b>	<b>23</b>	<b>202</b>
<b>5,000</b>	<b>53</b>	<b>502</b>
<b>10,000</b>	<b>A4</b>	<b>103</b>
<b>20,000</b>	<b>24</b>	<b>203</b>
<b>50,000</b>	<b>54</b>	<b>503</b>
<b>100,000</b>	<b>A5</b>	<b>104</b>
200,000	25	204
500,000	55	504
1,000,000	A6	105
2,000,000	26	205

Popular values listed in boldface. Special resistances available.

SHADED AREAS TYPICALLY NOT STOCKED BY DISTRIBUTORS AND NOT RECOMMENDED FOR NEW DESIGNS.

Specifications are subject to change without notice.